

RM-GB-8-N: Kombinationsmöglichkeiten von s88-Standardverbindungen und Busverbindungen nach s88-N über Patch-Kabel

RM-GB-8-N: Combinations of s88-standard connections and bus connections according to s88-N via patch cable

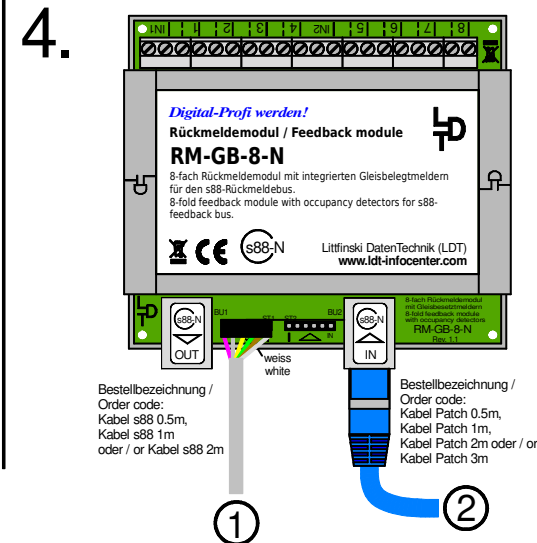
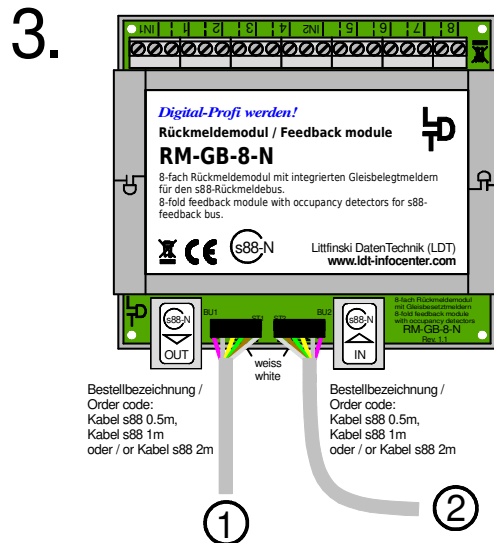
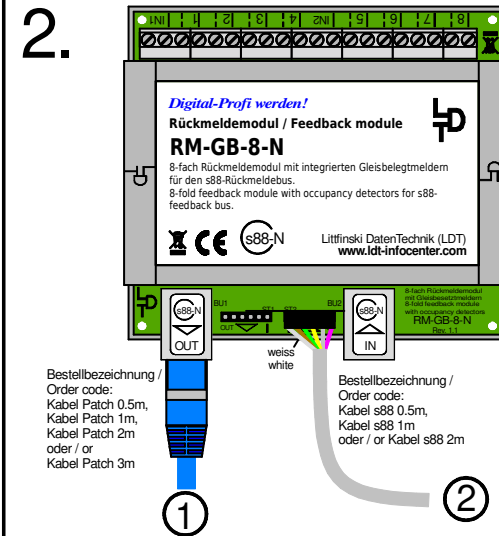
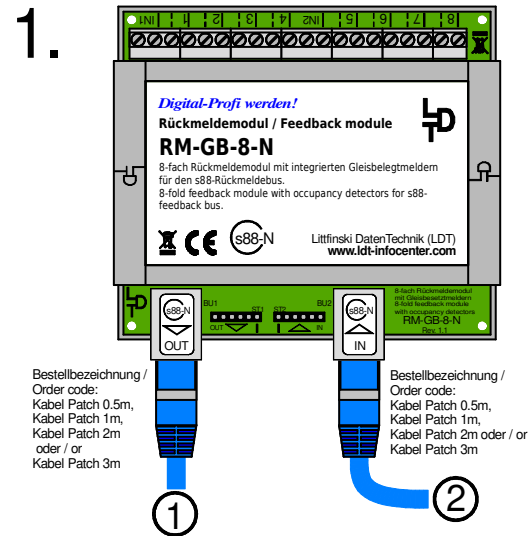

- ① s88-Busverbindung zu vorliegenden Rückmeldemodulen in Richtung Digitalzentrale oder HSI-88(-USB).
 s88-bus connection for the presented feedback modules in direction to the digital command station or HSI-88(-USB).

- ② s88-Busverbindung zu nachfolgenden Rückmeldemodulen.
 s88 bus connection for following feedback modules.

Technische Änderungen und Irrtum vorbehalten.
 Subject to technical changes and errors.
 © 04/2020 by LDT

